

Email Configuration for Android

Step 1: Connect to the Internet



Step 2: Click on Settings



Step 3: Click Add Account

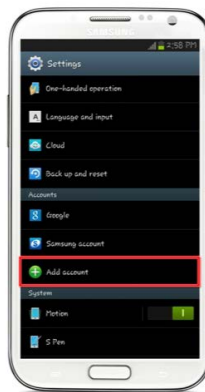

Step 4: Select Microsoft Exchange AcriveSync



Step 5: Fill in required fields



Step 6: Type in Domain, user name and server



Step 7: Choose options for synchronization

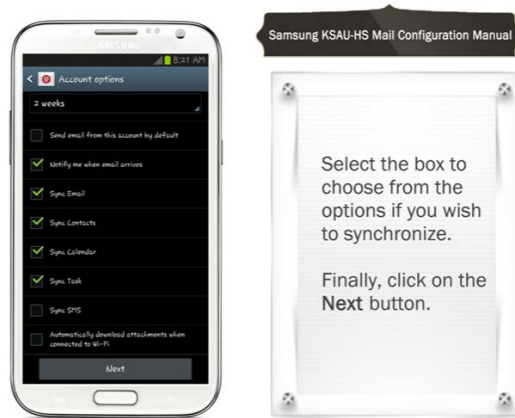

Step 8: Activate

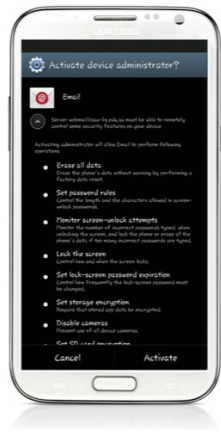

Step 9: Click Done



Step 10: You can find your email in the Mail application

